

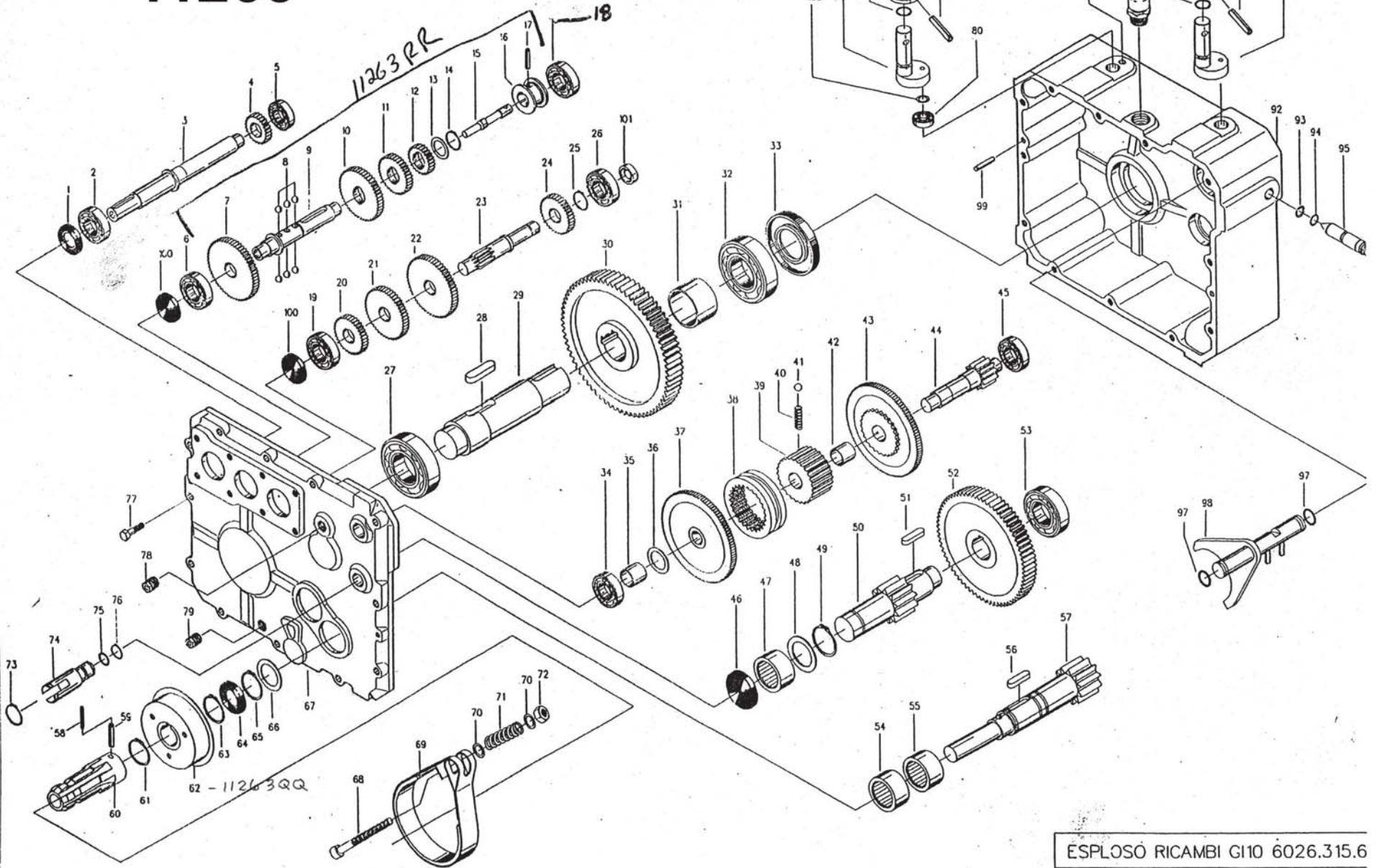

11263



11263 REF. #	Bondioli Part #	Amadas #	Description
0	6026.315.600	11263	GEARBOX,6SPD W/BRAKE DSENGAGE&
0		11263RBLT	GEARBOX,REBUILT #11263
1	8050.100.000	11263C	SEAL,INPUT SHAFT (20X35X6TC)
2	8200.164.001	11263P	BEARING,20X42X12 (6004 SKF)
3	2008.104.541	11263N	SHAFT,20MM INPUT; STRAIGHT
4	2008.020.442	11263DDD	GEAR,22 TOOTH
5	8200.136.001	11263Q	BEARING,15X35X11 (6202 SKF)
6	8200.128.001	11263R	BEARING,15X42X13 (6302 SKF)
7	2008.023.442	11263MMM	GEAR,58 TOOTH SHIFTER SHAFT DR
8	8525.152.000	11263SS	BALL,7/32" CHROME PLATED
9	2008.097.542	11263GGG	SHAFT,SHIFTER
10	2026.003.442	11263JJJ	GEAR,SHIFTER; 47 TOOTH
11	2026.002.442	11263KKK	REAR,34 TOOTH SHIFTER
12	2026.001.442	11263LLL	REAR,24 TOOTH SHIFTER
13	8550.280.000	11263HHHH	WASHER,18.0 X 27.9 X 1
14	8025.185.000	11263GGGG	RING,EXT.RETAINING(DIN471 D18E
15	2008.096.042	11263UU	ROD,SHIFT
16	2008.043.076	11263NN	HUB,GEAR SHIFT
17	8575.229.000	11263PP	PIN,ROLL 5X24
18	8200.136.001	11263Q	BEARING,15X35X11 (6202 SKF)
19	8200.128.001	11263R	BEARING,15X42X13 (6302 SKF)
20	2027.004.442	11263NNN	GEAR,34 TOOTH; 3RD MOTION
21	2027.005.442	11263PPP	GEAR,47 TOOTH; 3RD MOTION
22	2027.006.442	11263QQQ	GEAR,56 TOOTH; 3RD MOTION
23	2008.073.542	11263HHH	SHAFT,3RD MOTION
24	2008.070.442	11263RRR	GEAR,24 TOOTH; 3RD MOTION
25	8025.151.000	11263FFFF	RING,EXT.RETAINING(DIN471 D15E
26	8200.136.001	11263Q	BEARING,15X35X11 (6202 SKF)
27	8200.240.001	11263U	BEARING,35X72X17 (6207 SKF)
28	8125.362.001	11263CCCC	KEY,12X8X30 W/ROUNDED ENDS
29	2008.007.542	11263XX	SHAFT,35MM OUTPUT
30	2008.038.426	11263AAAA	GEAR,53 TOOTH FINAL DRIVE
31	2008.048.676	11263DDDD	SLEEVE,OUTPUT SHAFT SPACER
32	8200.264.001	11263T	BEARING,40X80X18 (6208 SKF)
33	8050.448.000	11263G	SEAL,OUTPUT SHAFT (40X62X10SC)
34	8200.128.001	11263R	BEARING,15X42X13 (6302 SKF)
35	8100.222.000	11263SSS	SLEEVE,18X20X15
36	8550.233.000	11359K	SLEEVE
37	2008.068.426	11263VVV	GEAR,LOW DRIVE
38	2008.039.076	11263WWW	HUB,SHIFTER; OUTER
39	2008.032.042	11263YYY	HUB,SHIFTER; INNER
40	8375.080.000	11263TT	SPRING,COMPRESSION, GEAR HUB
41	8525.152.000	11263SS	BALL,7/32" CHROME PLATED
42	8100.226.000	11263TTT	SLEEVE,20X23X15

11263 REF. #	Bondioli Part #	Amadas #	Description
43	2008.069.426	11263UUU	GEAR,HIGH DRIVE
44	2008.015.542	11263XXX	SHAFT,4TH MOTION
45	8200.164.001	11263P	BEARING,20X42X12 (6004 SKF)
46	8600.438.000	11263E	SEAL,FRONT BLANKING
47	8200.208.000	11263V	BEARING,30X27X12 NEEDLE(HK3012
48	8550.366.000	11263AA	SHIM,30.2X39.8X1
49	8025.302.000	11263Z	RING,EXT.RETAING (DIN471 D30E)
50	2008.016.542	11263BBBB	SHAFT,5TH MOTION
51	8125.300.000	11263EEEE	KEY,10X8X25 W/ROUNDED ENDS
52	2008.033.426	11263ZZZ	GEAR,70 TOOTH; 5TH MOTION
53	8200.192.001	11263S	BEARING,25X52X15 (6205 SKF)
54	8200.208.000	11263V	BEARING,30X27X12 NEEDLE(HK3012
55	8200.208.200	11263W	BEARING,30X37X20 NEEDLE(HK3020
56	8125.306.000	11263EEE	KEY,10X8X30 W/ROUNDED ENDS
57	2008.010.542	11263WW	SHAFT,PTO STUB
58	8575.160.000	11263QQQQ	PIN,ROLL, 3.5X40
59	8575.291.000	11263X	PIN,ROLL 6X40
60	2008.055.041	11263VV	SPLINE,PTO STUB, 1-3/8 - 6
61	8025.302.000	11263Z	RING,EXT.RETAING (DIN471 D30E)
62	2008.121.041	11263QQ	HUB,BRAKE BAND
63	8025.302.000	11263Z	RING,EXT.RETAING (DIN471 D30E)
64	8050.256.000	11263F	SEAL,PTO/BRAKE (30X40X7SC)
65	8025.302.000	11263Z	RING,EXT.RETAING (DIN471 D30E)
66	8550.366.000	11263AA	SHIM,30.2X39.8X1
67	2008.002.201	11263ZZ	CASE,GI10, FRONT HALF
68	8675.213.000		Use standard bolt
69	2008.012.098	11263A	BAND,BRAKE
70	8500.189.000	11263LLLL	WASHER,USE G120393,5/16 FLAT W
71	8375.200.000	11263B	SPRING,BRAKE TENSION
72	8225.251.000	11263MMMM	NUT,USE G11505915, 6MM NUT
73	8025.210.000	11263M	RING,EXT. RETAINING,BRAKE&POST
74	2008.052.048	11263JJJJ	SHAFT,BRAKE BAND MOUNT
75	8075.115.000	11263CC	O-RING,2.62X10.78
76	8025.162.000	11263JJ	RING,EXT.RETAINNG(DIN471 D16E)
77	8675.189.080	11263NNNN	SCREW,USE G11500716;M8X30
78	8625.136.000	11263K	PLUG,OIL SIGHT
79	8600.144.000	11263J	PLUG,DRAIN
80	8200.024.001	11263LL	BEARING,5X16X5 (625 SKF)
81	2008.041.098	11263KK	LEVER,CONTROL
82	8075.115.000	11263CC	O-RING,2.62X10.78
83	2008.040.041	11263BBB	CAP,SHIFT LEVER, GEARS
84	8575.291.000	11263X	PIN,ROLL 6X40
85	8525.200.000	11263GG	BALL,5/16" CHROME PLATED
86	8375.160.000	11263HH	SPRING,UNI3823 (COMPRESSION)

